

THE INFORMATION ON THIS DOCUMENT IS THE PROPERTY OF BHARAT HEAVY ELECTRICALS LIMITED. IT MUST NOT BE USED DIRECTLY OR INDIRECTLY IN ANY WAY DETRIMENTAL TO THE INTEREST OF THE COMPANY

GENERAL DIMENSIONAL LIMITS, FITS & TOLERANCES AS PER HY0230261

INVENTORY NO
SIGN. AND DATE
REF. DRG. NO.
COMPUTER FILE NAME

18-06-2009
11:53:33

FIRST ANGLE PROJECTION

(ALL DIMENSIONS ARE IN mm)

DRG. NO. 1-301-19-00001
SH. OF 01

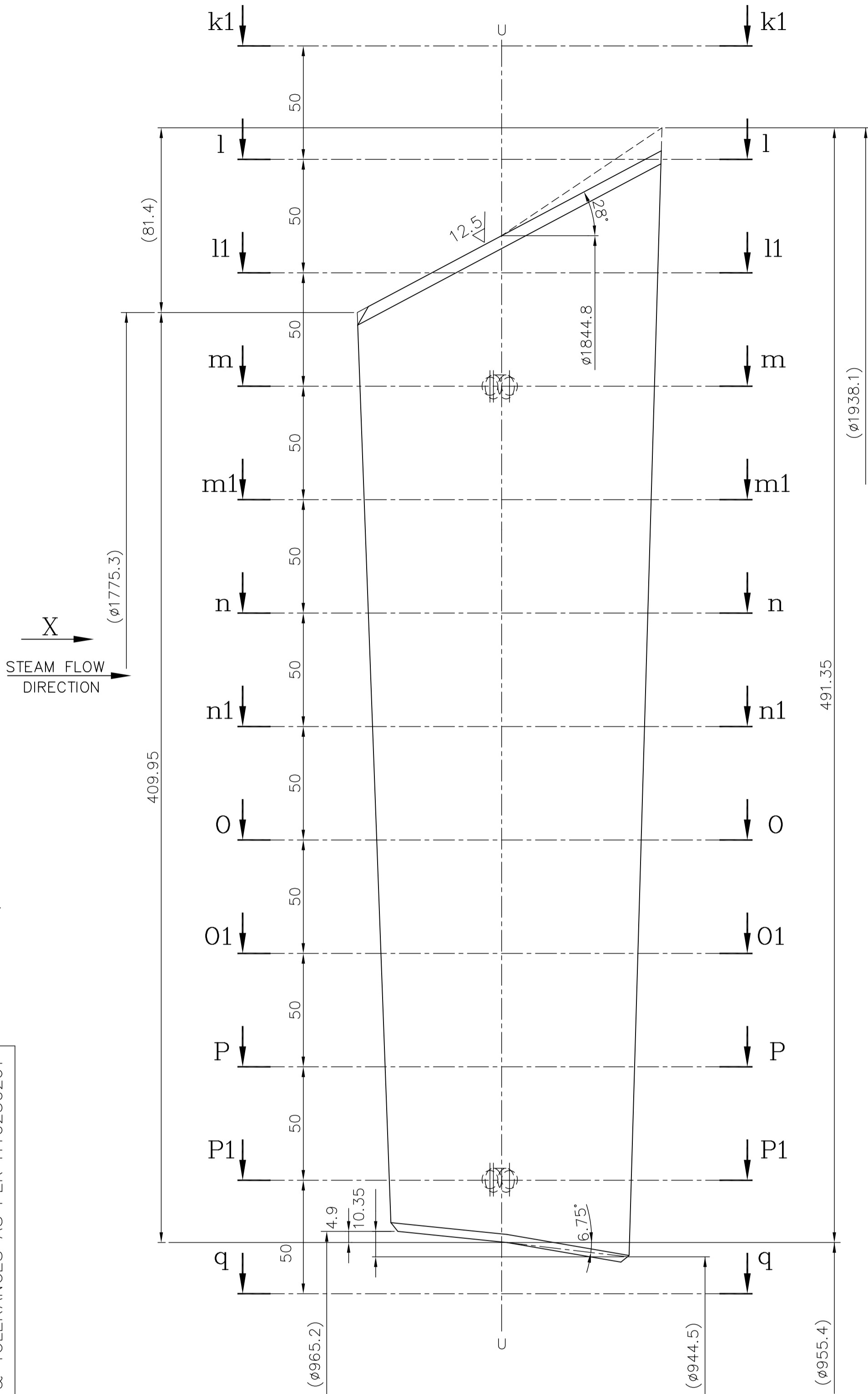

VIEW-X

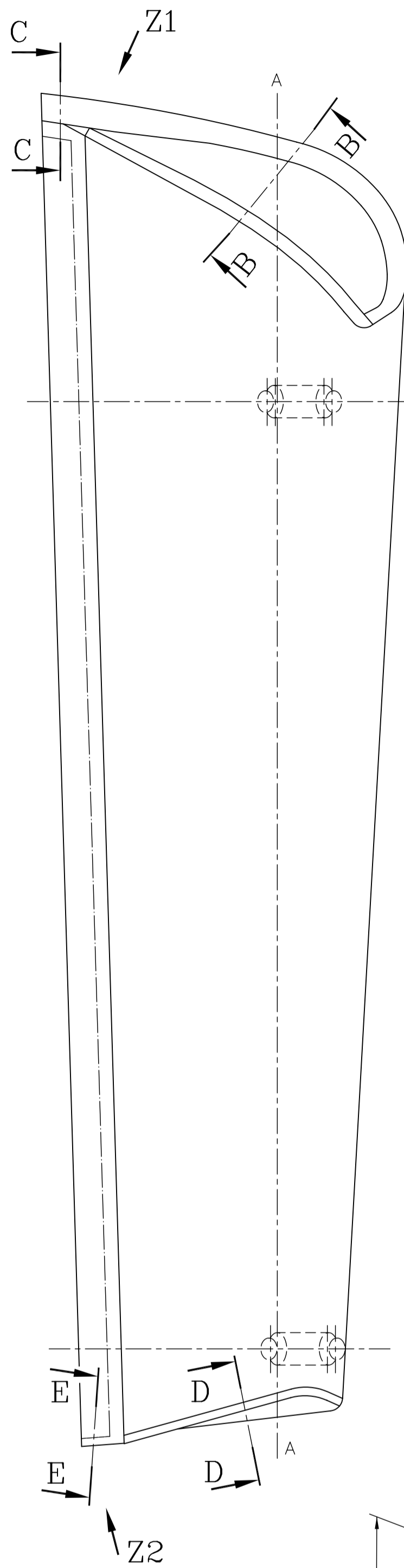

POSITION OF PIN HOLES IN THE SHEET DEVELOPMENT

	SUCTION SIDE	PRESSURE SIDE
n	10	7
XB	47.95	37.82
YB	-7.89	-6.17
XA	78.64	58.65
YA	438.3	430.31
L1	33.31	31.61
L2	350.09	350.03
D	12.4	12.4

SECTION B-B

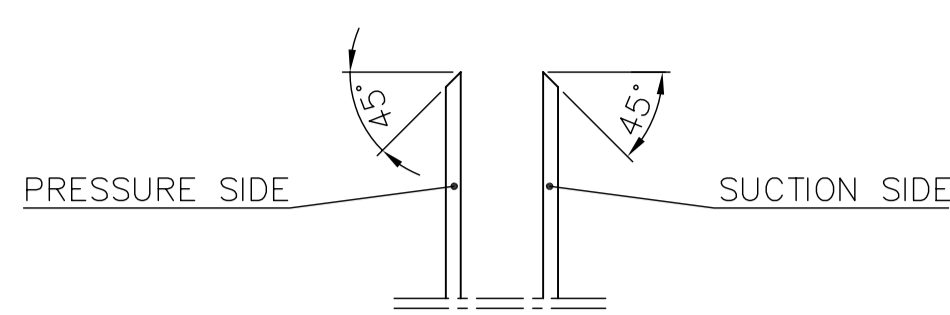

SECTION C-C

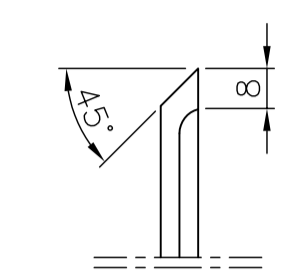

VIEW Z1

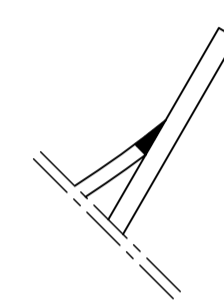

SECTION D-D

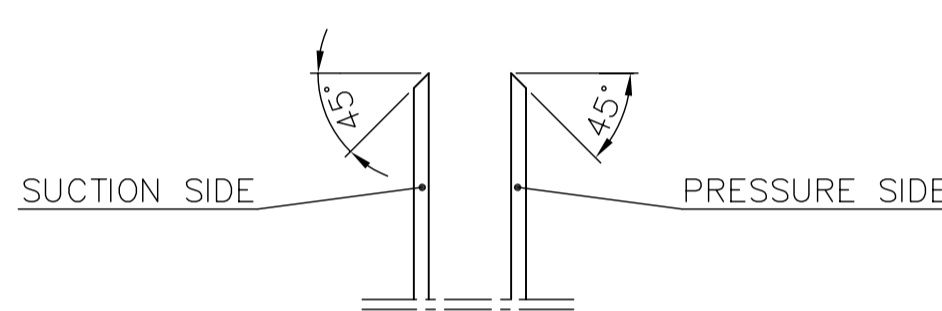

SECTION E-E

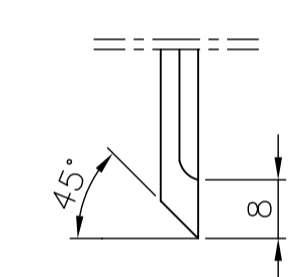

VIEW Z2

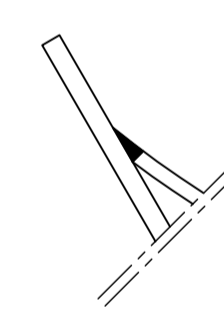

DIRECTION OF ROTATION IS ANTICLOCKWISE WHEN SEEN IN THE DIRECTION OF STEM FLOW

NOTES:

1. DEVELOPMENT OF HALLOW GUIDE BLADE PROFILE AS PER DRG. NO. 3-301-19-00001-00.
2. PROFILE CO-ORDINATES AS PER DRAWING NO. 3-301-19-00002-00 (12 SH)
3. WELD CLASSIFICATION ,INSPECTION, TESTING AND ACCEPTANCE AS PER STANDARD AA0622101 GRADE-I
4. PROFILE F 25-110/320-1400

DRAWING IN
THIRD ANGLE
PROJECTION

00
VAR

TYPE OF PRODUCT OR NAME OF CUSTOMER/PROJECT				NAME	SIGN.	DATE	NO.OF VAR.
BHARAT HEAVY ELECTRICALS LTD. HYDERABAD				J.C.S./TSP		27.04.2000	
T.S.PRABHAKAR				C.N.V.RAM		27.04.2000	-N.A.-
APPD.							
DEPT.	UNTOL.	DIMS.	SCALE	WEIGHT (KG)	REF. TO ASSY. DRG.	ITEM NO.	NO.OF ITEMS
L.T.D.	GR.		1:1.5	-	NA	-N.A.-	-N.A.-
CODE.							
415							
TITLE				CARD CODE	DRAWING NO.	REV.	
L.P GUIDE BLADE-3L				N.A.	1-301-19-00001	05	
(ND 3/562-3.6) (2.8 Sqm.-3L)							
					SHT. No 01	NO. OF SHT. 01	